

# WESTLUND

## MODIFIED ATMOSPHERE PACKAGING MACHINERY

### SEMI-AUTOMATIC MODEL 1000

#### FLOOR PLAN:

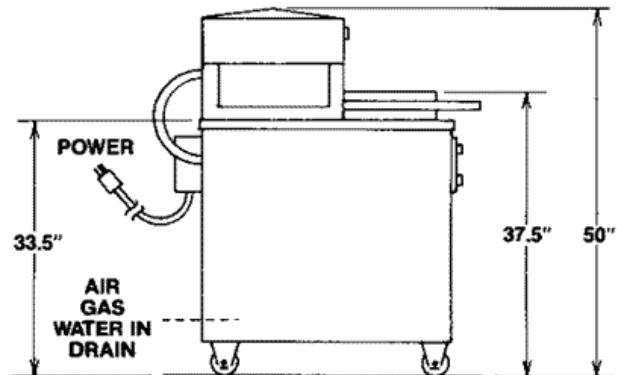
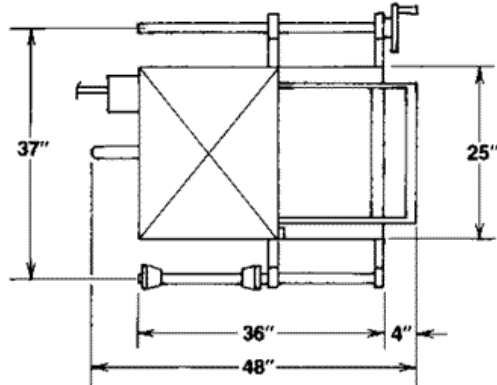

#### MODEL 1000 PRODUCT BENEFITS:

- Solid construction using aluminum tooling plate and stainless steel
- Self contained vacuum pump
- Quick changeover tooling to cut downtime in changing package configurations. Model changeovers can be accomplished in less than 30 minutes.
- Versatile tooling accommodates individual package size from 1" x 2" to 12" x 14" with a maximum package depth of 5".
- The unique gas back fill feature enables

the system to achieve residual oxygen levels of less than 1% from package. Up to three gases may be mixed and back filled on line.

- Service and parts are readily available.

#### Specifications:

Power	208/220, (480 optional AC)
Vacuum	Self contained

At your request, a company representative will analyze your application and recommend the proper equipment

# WESTLUND

## ENGINEERING INC.

12400 44<sup>TH</sup> STREET NORTH, CLEARWATER, FL 33762 P 727.572.4343 F 727.572.6811  
WEBSITE: WWW.WESTLUNDENG.COM EMAIL: WESTLUND@WESTLUNDENG.COM